

①



②



②



1.

2.

70

3.

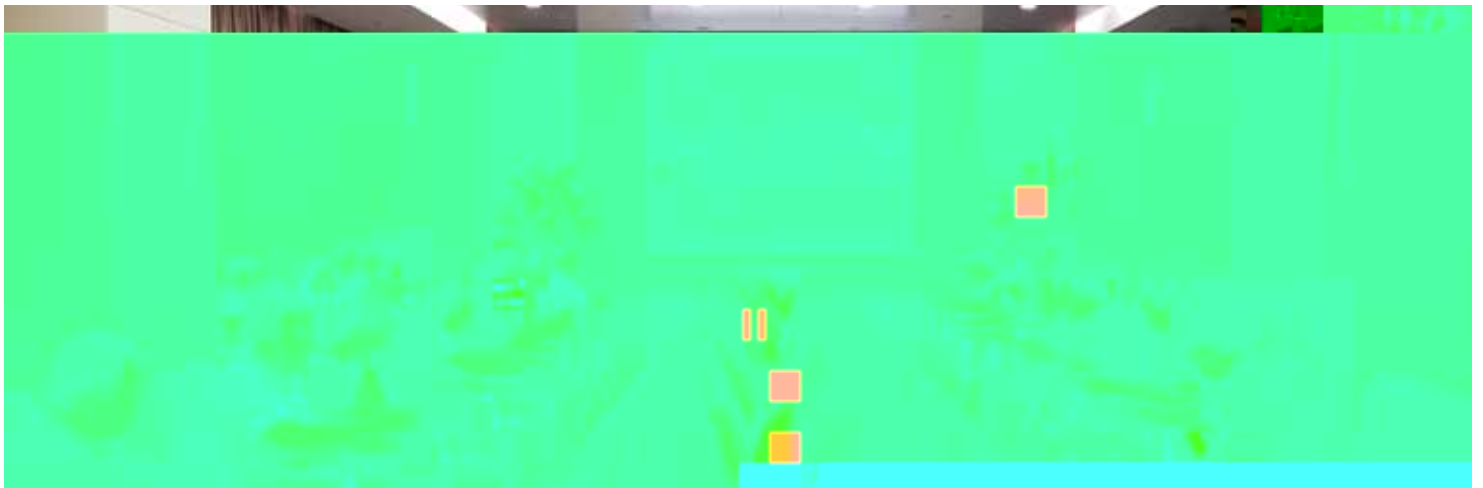

③

“ ”

“ ”

“ ”

“ ”

“ ”

S

Contents

2015 8 95



1 “ ”

4 2015 500 50

5

6 2015

8

9 “ ”

10

媃媃

16

17

2 100036

010- 68138072 /68138057

zhgjctx@126.com

26

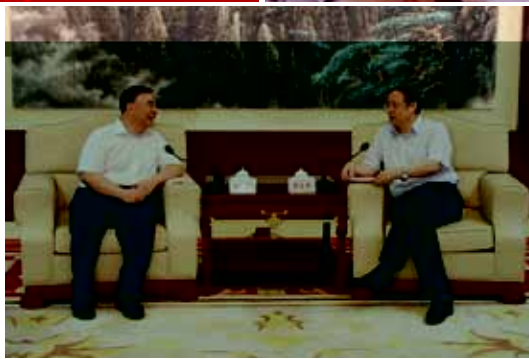

31

——

“ ”

IC

43

34

44

——

38

——

46

8

41

——

0 1

48

8





8	22			
	2015	500		500
			"	
		"		2504
		2015	500	50
	500	17		

				"
"				
		"	"	
500				

	"	"
30		



8 4

100

1.5G W

1.5G W



8	24		2015	
	8	25		10%
			2015	KPI
2015			483	
13%	25.5		37%	
1.32			1.4%	
6.6	2.9%		2,868	
	81%		53	
13%	31		5%	
	2015			
			30	
	61.45%			
	"		"	
"			"	
"			"	
"			"	

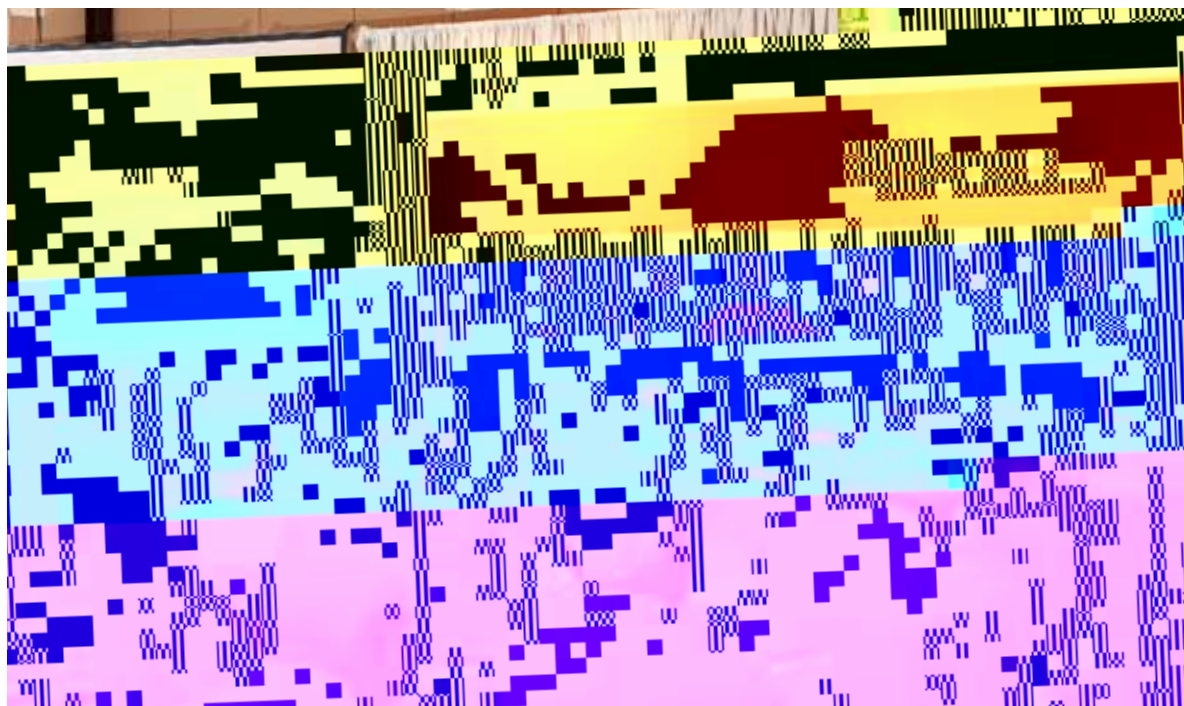

8

0 4



8 14

"

"

L

" "



9

“

”

“

”

“

”

“

”

,

"

"

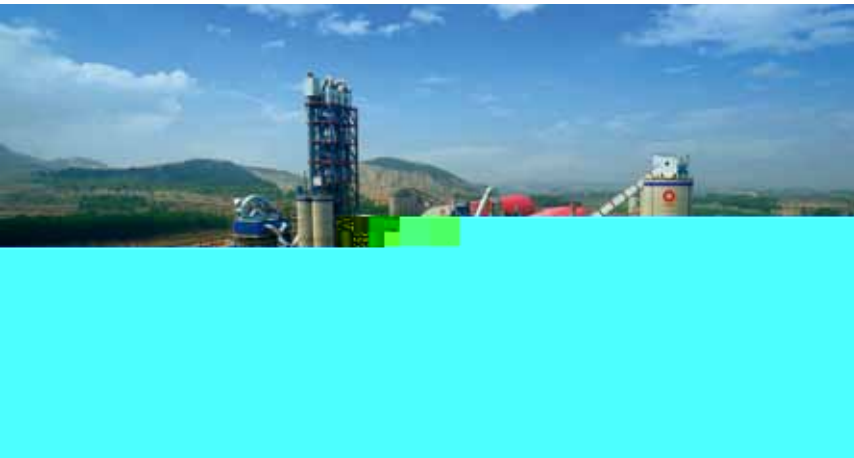

工业4.0智能化管理的生产线

“ ”

20

“ ”
“ ”

“ ”

“

”

“ ” 1.3

“ ”

0

1 1 N

”

”

“ ” “ ” “ ” “ ”

30

“ ” “ ” “ ” “ ” “ ”

“ ” “ ” “ ” “ ” “ ” “ ”

“ ” “ ”

50%

“ ” “ ”



“ ” “ ” “ ” “ ”

“ ” “ ” “ ” “ ”

8

300

5.0

“ ”



“

35

1993

“

”

“

36

“

”

”

”

”

2002

”

”

“

”

40

”

”

1979

4

10

10

14

5

500



点燃北新员工心中之火



任职国药期间
调研企业

— —

2009 4 20 2500

“ ”

“ ”
2000 400

“ ”
“ ”
“ ”
“ ”
“ ”

“ ”

一、关于企业的发展观



“ ”
“ ”
“ ” “ ” “ ”

“ ”

GDP

“ ”

“ ”

“ ”

GDP

7%

“ ”

30%

“ ”

“ ”

“ ”

30

“ ”

GDP

“ ”

0.618

60

80

KDDI

500



宋志平为中青年干部培训授课

GDP GNH

1970

GDP 700

69%

100 140

CRH CEO

四、企业的管理

“ “

“ “

5000

150

300

100



" " " " " "

" " 5.0" "

24

"

"

"

24



500

q

3

3

"

"

"

"

18

30

"

"

"

"

"

"

"

"

"

"

"

"

"

"



"

"

"

"



“ ”
” ”

3

“ ” “ ” “ ”

1.

” ”

” ”

2.

2009

80%

KPI



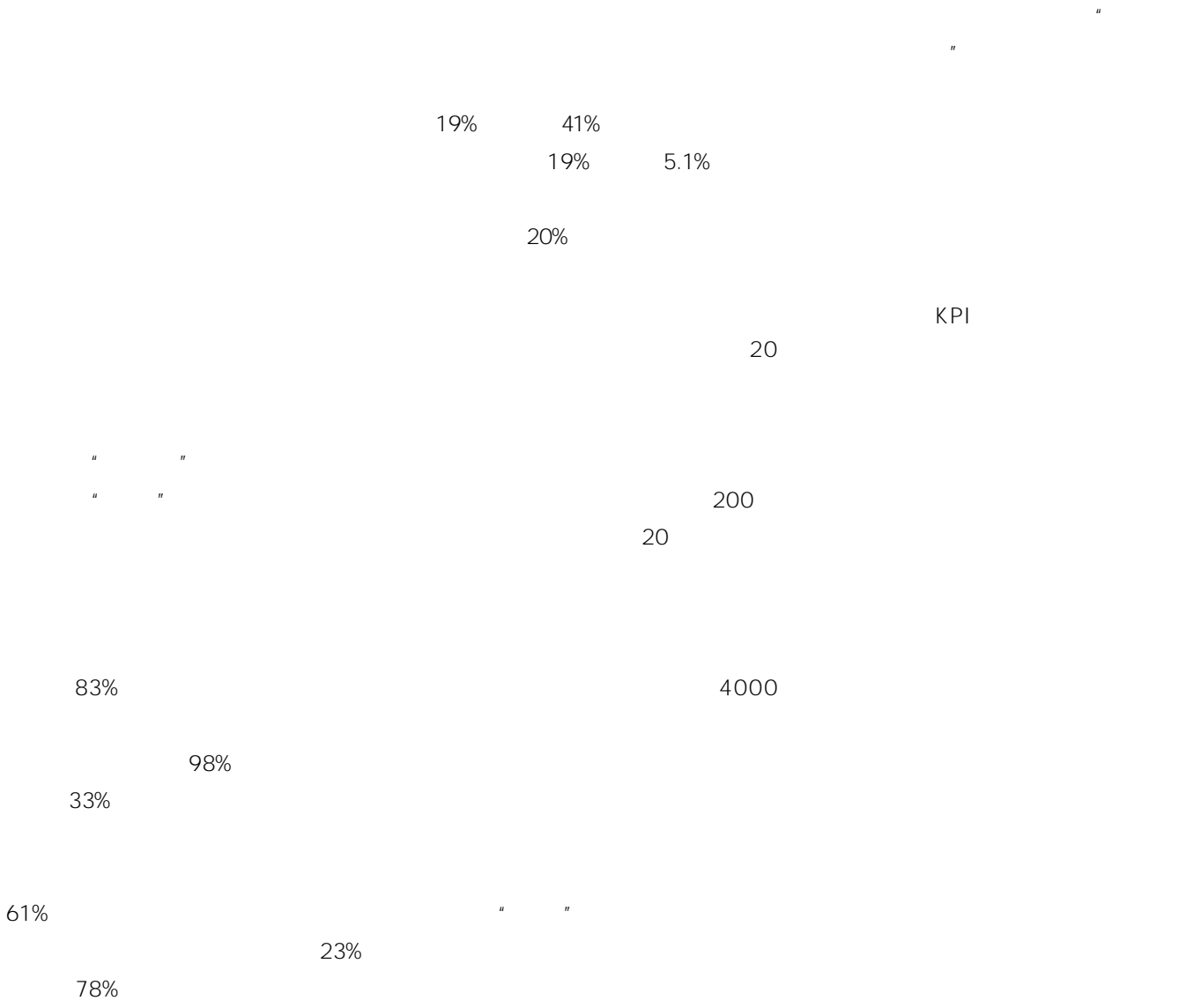

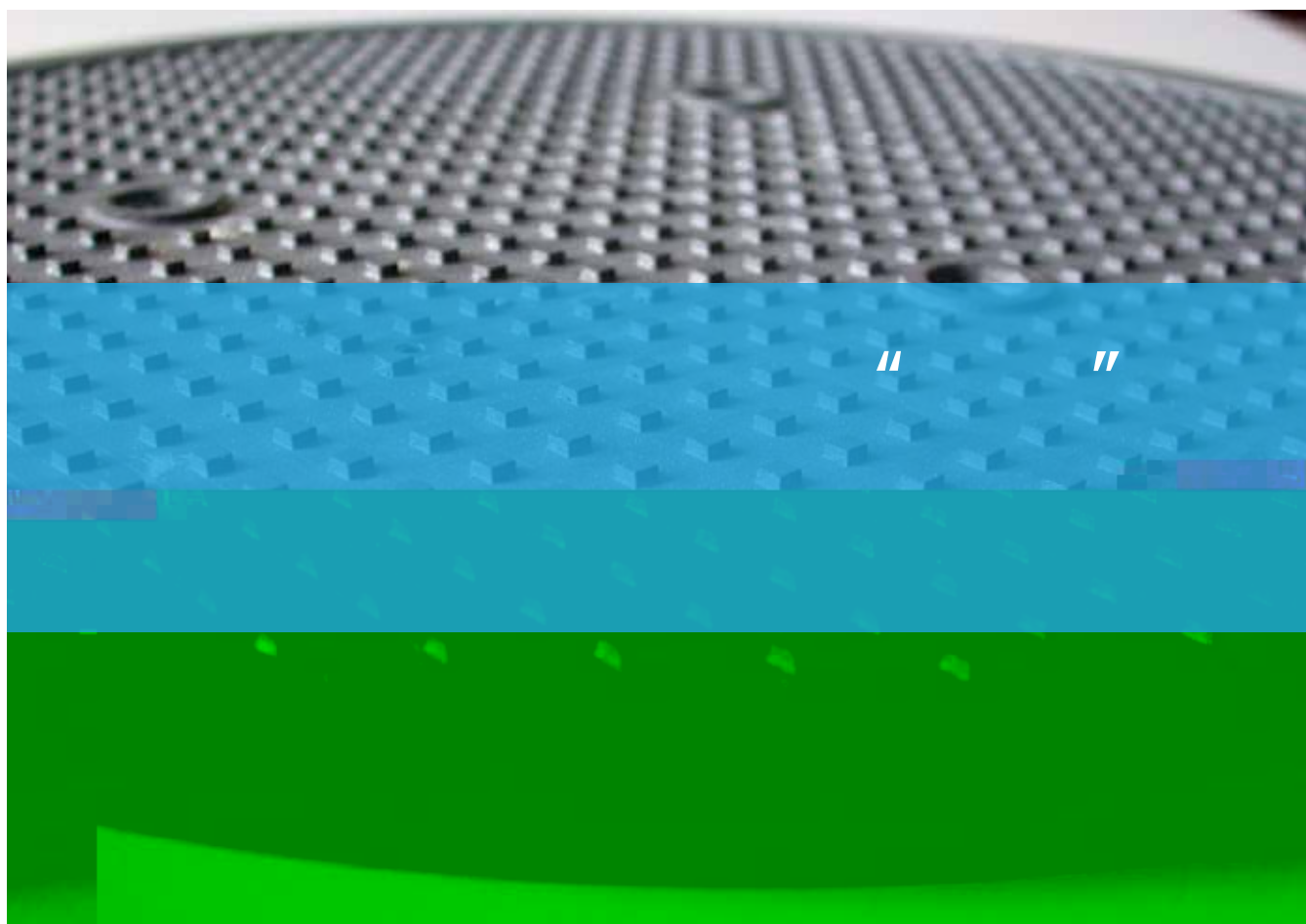

1912
20 20

20 50

60
70

IC

80

1905

IC
90
21
60%

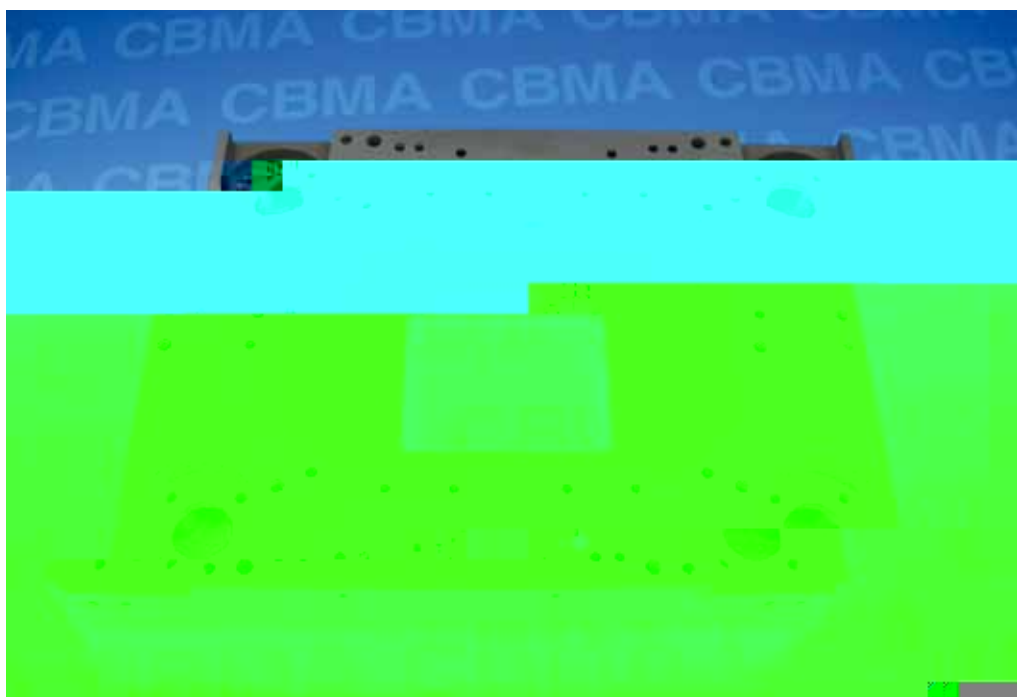

中国建材总院研制的碳化硅工件台

2012

300 8
400
1
1 × 1

1

“ ”
“ ”

IC



10

"

"

1000

"
"
"

2008

"

"

2015

34

15

5

10

10

“ ”
“ ”
2009
“ ”



2007 11

“ ” “ ”
“ ” “ ”
“ ”

“ ”
“ ” 40
7 “ ”

“ 79”
647 “ 79”
1372

“ ”
2014

GPS 80
“ ”

做事 快E 傲人

#"

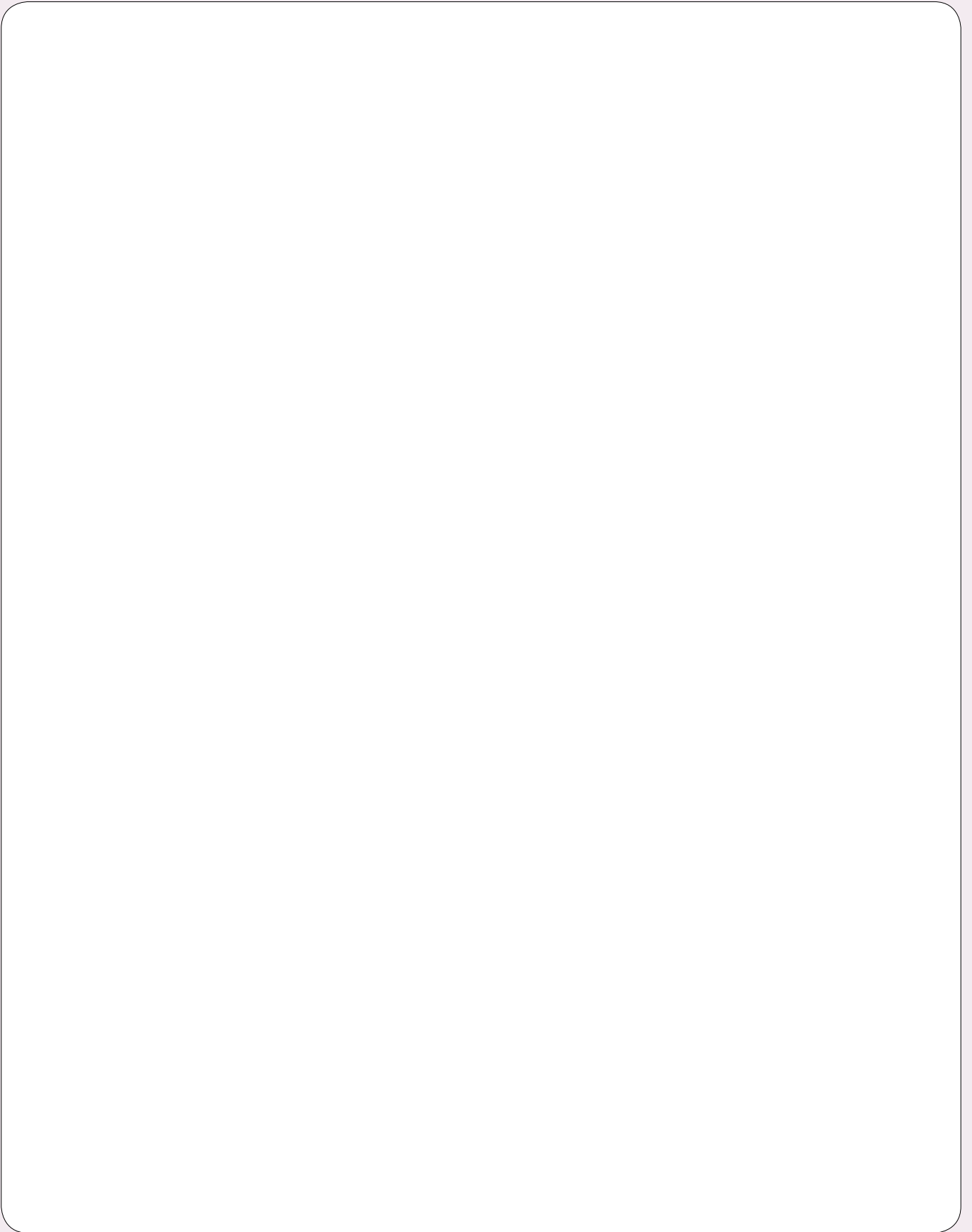

不断 复制后 做些什么

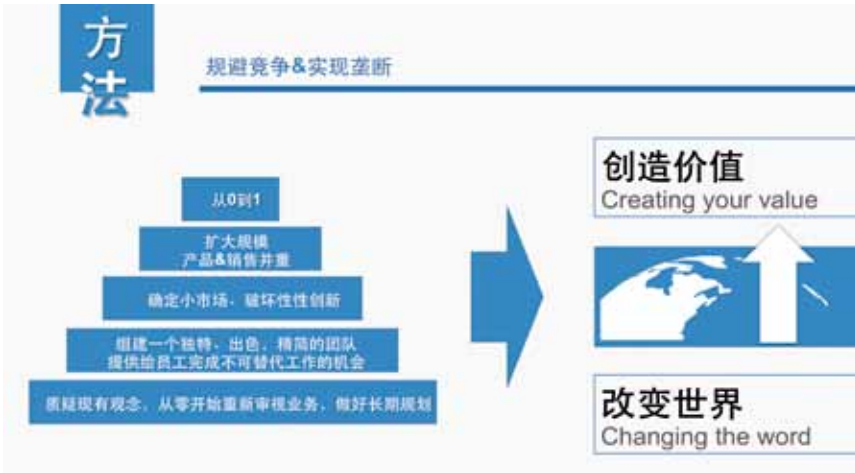

9aaY^W

VS

9aaY^W

9aaY^W

/

v

9aaY^W

9aaY^W

fi

9aaY^W

v

v

9aaY^W

v

VS

v

9aaY^W

9aaY^W

探寻基业长青的秘密

(\$+) %

#" "

v

l

#S

EA: A

/EUZ` WVVd

7^Wfd[U E3fi #*%(

#) +

' ""

#" " [` fVd` W

#" #+*)

— —

6 9 10

" "

"

"

.....

— —

"

"

"

"

" — — — — "

— —

" cucc"

" "

— "
.....
..... "

11 00

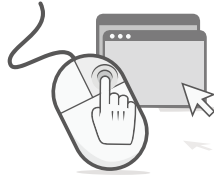

01

03

2012

2012

04

02

8 20



8 6

4160

05

8 3

Votorantim

Edvaldo Araujo Rabelo



Votorantim

1936

50

06

07

"

"

19

08

"

"

8 1

"

"

CTC



8 18



1- 7

			2.2		253659.4	
	3.6%	1- 7				
6.1%	153752.6		7.6%		246115.6	
	5.6%					
2.2%	0.3%	4.9%	146539.3		7.4%	
			6.5%	1.7%	1.1%	
	14157.9		2.3%	10046.7		
4.5%	1- 7					



8 22

6

1937.12.13
-1938.1

南京！南京！

—

30

30

30

30

